

Checklist of Orchids in the Courtneys Road area, South Belgrave

(prepared by P.H.T. Uhlherr and B.A. Fuhrer)

1. The area is defined in the attached sketch-map.
2. The authors have observed orchids in the area from 1967 to 1983 during all seasons; two major fires have swept the area in this period.
3. The orchids observed in the labelled grid squares (see map) are listed in alphabetical order together with the grids in which they have been recorded. Where species have not been seen by us, the source of the record is given.
4. Sixty-one species\*, three varieties and an unnamed hybrid have been recorded for the area.
5. A number of species not recorded in the area do however, occur in contiguous regions and may be observed in the area in future.

\* Representing about one third of the orchid species recorded for Victoria

From  
Murray & Ivy Howell  
0596684499.

With compliments

P.H.T. Uhlherr  
15/9/84.

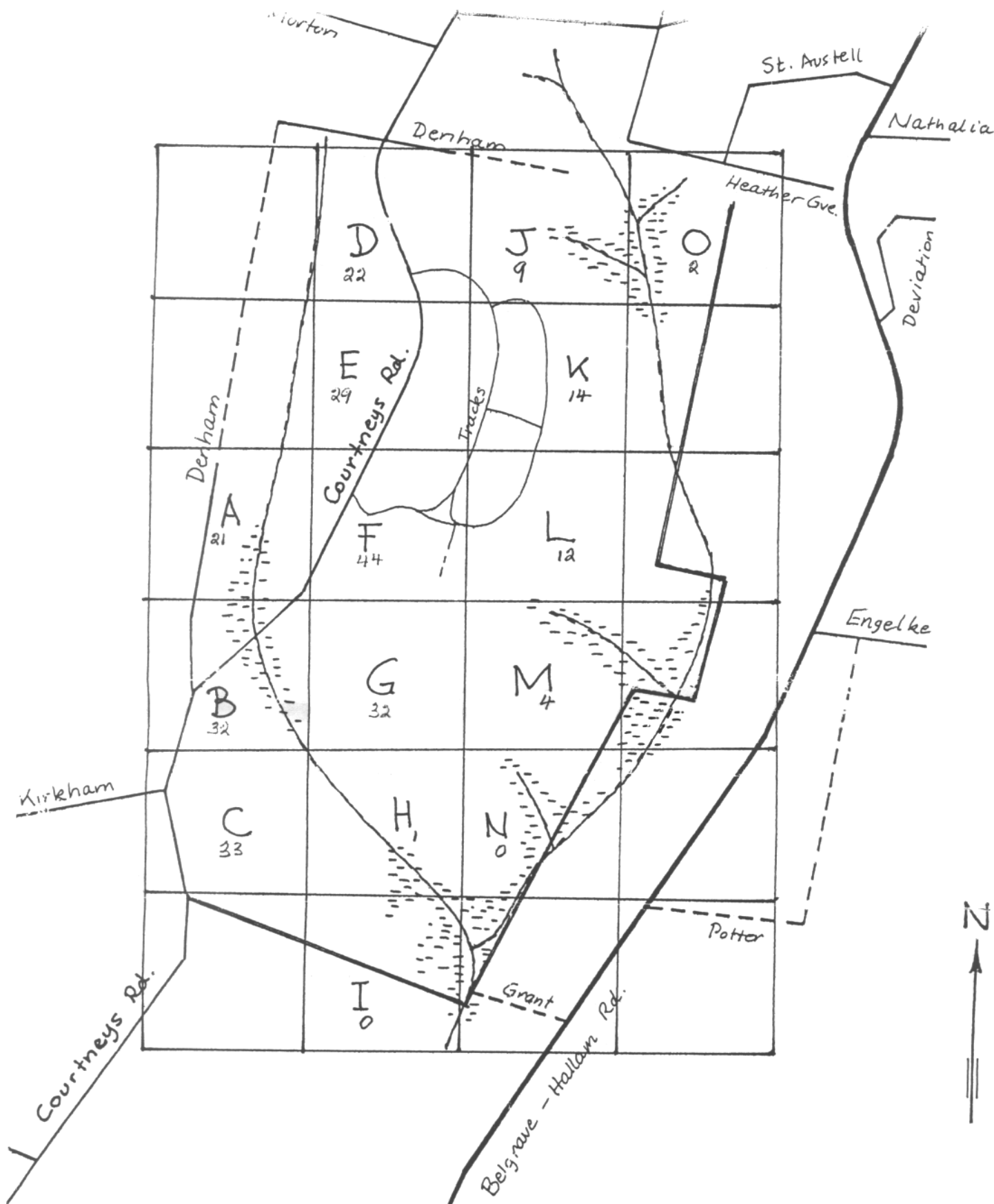

PETER UHLHERA  
SEPT 1983

scale (approx.)  
500 m

— fenceline  
--- creek and

Acianthus	caudatus	B C D E F G K L M
	exsertus <i>pusillus</i>	A B D E F
<i>now CYATOSTYLIS</i>	reniformis	F G
Caladenia	alba var. <i>picata</i> <i>catenata</i> C	
	angustata <i>gracilis</i>	B C F G
	caerulea	F L
	catenata ( $\equiv$ <u>c. carnea</u> )	A B C D E F G J K L
	var. pygmaea	F G
	var. gigantea	F
	clavigera	F
	congesta	F G
	deformis	B E F G K L
	dilatata	B C E F G H K L
	var. concinna	(Mrs. I. Dunn)
	iridescens	E F
	menziesii	(Miss M. Allander)
	patersonii <i>oenichila</i>	B C D E F G K L
	praecox	F L
Calochilus	campestris	C
	paludosus	C D E F
	robertsonii	A B C D E F G
Chiloglottis	gunnii	A D J K
Corybas	diemenicus <i>incurvis</i>	A B F J
	dilatatus <i>diemenicus</i>	A
	unguiculatus	F
Cryptostylis	leptochila	A B D E F G L
	subulata	F G
Diuris	longifolia <i>orientis</i>	A B C D E F G
	longifolia x pedunculata	C G
	maculata <i>pardina</i>	A B C F G
	pedunculata <i>chryseopsis</i> C	
Dipodium	punctatum <i>roseum</i>	A B D E F G

*the only greencomb then  
(includes C. parva, C. phaeclavia  
& P. tentaculata)*

Eriochilus	cucullatus	A B C D E F G L M
Gastrodia	sesamoides	C D E
Glossodia	major	A B C D E F G K L M
Lyperanthus	suaveolens	B C D E
Microtis	biloba <i>arenaria</i>	C
	oblonga <i>rara?</i>	G
	parviflora	F
	unifolia	A B C D E F G
Orthoceras	strictum	F
Prasophyllum	*archeri	K
	braineii <i>lindleyana</i>	B C D
	xdespectans	E F K
	elatum	B C D E F G J K L
	fuscum	D
	gracile	D
	xmorrisii	F G K
* CORUNASTYLIS	odoratum	B C D E F
Pterostylis	alpina	A B D E F G J
	plumosa ( $\equiv$ barbata)	A C
	concinna	F G
	curta	D E
	decurva	D J O
	falcata	(Mrs. I. Dunn)
	grandiflora	A B D E F G J
	longifolia <i>melagramma</i>	A B C D E F G J
	nana	B C D F G K
	nutans	A B C D E F G
	parviflora	A B C D E F G
	pendunculata	A B C J O

Thelymitra	antennifera	B C G
	carnea	B C F
	flexuosa	E F
	ixioides	B C D E F G K L M
	macmillanii	C
	media	D E F K
	pauciflora	A B C D E F G
	rubra	B C D F

Species recorded in the immediately surrounding areas

Corybas despectans	(B. Fuhrer, P.H.T. Uhlherr)
Pterostylis truncata	(J.H. Willis)
Pt. curta x nutans	(B. Fuhrer, P.H.T. Uhlherr and others)
Pt. rufa	(B. Fuhrer and others)
Microtis atrata	(J.H. Willis)

Species for which the habitat is suitable (B, H, I) and which could be expected in the area

Burnettia cuneata  
Microtis atrata